

# Chocolate Suction Cups SPG

Suction area (Ø) 33 mm

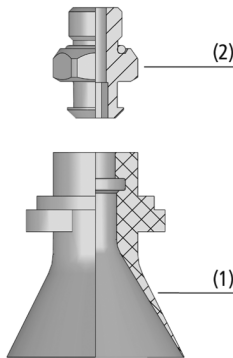

Chocolate Suction Cups SPG



System Design Chocolate Suction Cups SPG



Chocolate suction cups SPG being used for handling chocolates

## Suitability for Industry Specific Applications

### Applications

- Bell-shaped suction cup for dynamic handling and packing of chocolates in combination with picker robots
- Direct handling of round, oval or square chocolates
- Handling of confectionery with structured surfaces or toppings
- Due to the use of FDA-compliant silicone, the contact with food is harmless
- Handling of round chocolates with maximum diameter of 35 mm and oval/square chocolates with maximum diagonal measurement of 30 mm

### Design

- Suction cup (1) with extremely thin, soft sealing lip and tapered suction cup geometry
- Optimal sealing lip shape for handling workpieces with structured surfaces
- Use of one-piece insertable connection element (2), with G1/8" male or female thread, for changing the suction cup quickly
- Connection element with male thread has an integrated seal

### Product Highlights

- Extremely thin sealing lip optimized for decorated chocolates
- Conical shape safely encloses even square pralines; highest dynamics possible
- High nominal flow compensates for leakages due to highly structured chocolates
- Suction cup made of FDA compliant silicone suitable for direct food contact

# Chocolate Suction Cups SPG

Suction area (Ø) 33 mm

## Designation Code Chocolate Suction Cups SPG

<b>SPG</b>	–	<b>33</b>	–	<b>SI-45</b>	–	<b>SC040</b>
1		2		3		4

### 1 – Abbreviated designation

Code	Version
SPG	Bell-shaped

### 2 – Suction area

Code	Diameter in mm
33	ø 33

### 3 – Material

Code	Material
SI-45	Silicone
SI-HD	Silicone

### 4 – Connection

Code	Connection
SC040	SC040

Suction cup SPG (elastomer part + connection element) is delivered assembled. The assembly consists of:

- Suction cup of type SPG – elastomer part
- Connection element of type SC – available with various threads

## Ordering Data Chocolate Suction Cups SPG

Type*	Part no.
SPG 33 SI-45 SC040	10.01.19.00002
SPG 33 SI-HD-65 SC040	10.01.19.00165

\*Additional material specifications at beginning of the section "Vacuum Suction Cups"

## Ordering Data Accessories Chocolate Suction Cups SPG

Accessories	Part no.
Schmalz-Connector SC 040 G1/8-IG	10.01.06.02482
Schmalz-Connector SC 040 G1/8-AG	10.01.06.02490

## Technical Data Chocolate Suction Cups SPG

Type	Volume [cm <sup>3</sup> ]	Hose diameter (recom.) d [mm]*	Nipple family
SPG 33 SI-45 SC040	8.1	4	SC 040
SPG 33 SI-HD-65 SC040	8.1	4	SC 040

\*The suction force and operating vacuum are dependent on the geometry and surface characteristics of the chocolate. We recommend a maximum operating vacuum of -150 mbar.

# Chocolate Suction Cups SPG

Suction area ( $\emptyset$ ) 33 mm

## Design Data Chocolate Suction Cups SPG

---

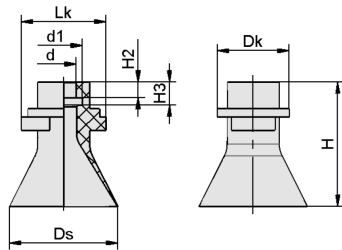

---

SPG

## Chocolate Suction Cups SPG

Suction area (Ø) 33 mm

### Design Data Chocolate Suction Cups SPG

Type*	d [mm]	d1 [mm]	Dk [mm]	Ds [mm]	H [mm]	H2 [mm]	H3 [mm]	Lk [mm]
SPG 33 SI-45 SC040	7.3	11	21.5	32.1	38	4.8	7	25.5
SPG 33 SI-HD-65 SC040	7.3	11	21.5	32.1	38	4.8	7	25.5

\*Acceptable dimensional tolerances for rubber parts concerning to DIN ISO 3302-1 E3