

# Inline Ejectors SLP

Suction rate from 8 l/min to 16 l/min

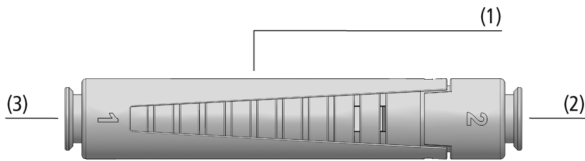

Inline Ejectors SLP



System Design Inline Ejectors SLP

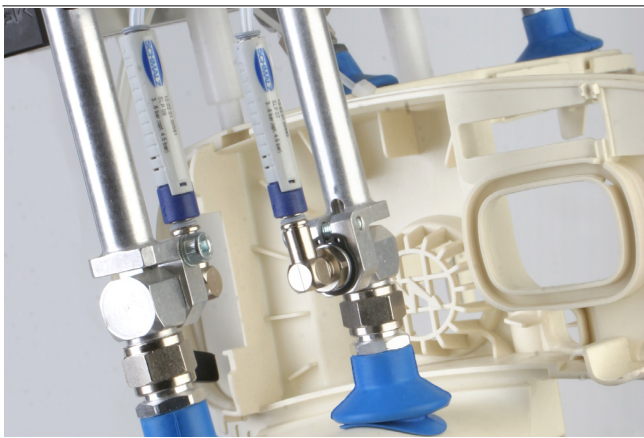

Decentral vacuum generation by inline ejectors SLP when handling plastic injection molded parts

## Suitability for Industry Specific Applications

### Applications

- Inline ejector for mounting directly in the hose line
- Handling of electronic components
- Vacuum generation in handling systems with restricted space
- Use in separation systems for plastic and sheet-metal machining

### Design

- Two piece housing made of light, impact resistant plastic (1)
- Axial connection of compressed air (3) and vacuum (2) with quick action push-in couplings for hose diameter 4 mm
- Vacuum generator with single-stage nozzle with 0.5 and 0.7 mm diameter
- Air outlet with good flow characteristics
- Attractive industrial design in a slim "10 mm" construction

### Product Highlights

- Inline ejector with axial connections for installation directly into the hose line
- Ideal for highly dynamic processes due to its low weight (5 g)
- Optimized air consumption with high suction rate and vacuum value
- Slim plastic housing allows installation even in the smallest of spaces
- Push-in connection saves additional connection elements

# Inline Ejectors SLP

Suction rate from 8 l/min to 16 l/min

## Designation Code Inline Ejectors SLP

|            |   |           |   |            |
|------------|---|-----------|---|------------|
| <b>SLP</b> | - | <b>05</b> | - | <b>S01</b> |
| 1          |   | 2         |   | 3          |

### 1 – Abbreviated designation

| Code | Version |
|------|---------|
| SLP  | SLP     |

### 2 – Nozzle size

| Code    | Diameter in mm |
|---------|----------------|
| 05...07 | ø 0.5 and 0.7  |

### 3 – Connection

| Code | Connection                       |
|------|----------------------------------|
| S01  | Quick connect push-in coupling 1 |

Inline ejector SLP is delivered as a ready-to-connect product.

## Ordering Data Inline Ejectors SLP

| Type       | Part no.       |
|------------|----------------|
| SLP 05 S01 | 10.02.01.00561 |
| SLP 07 S01 | 10.02.01.00562 |

## Technical Data Inline Ejectors SLP

| Type       | Nozzle diameter [mm] | Degree of evacuation [%] | Suction rate (max.) [l/min] | Suction rate (max.) [m³/h] | Air consumption suction [l/min]* | Air consumption suction [m³/h]** |
|------------|----------------------|--------------------------|-----------------------------|----------------------------|----------------------------------|----------------------------------|
| SLP 05 S01 | 0.5                  | 85                       | 8                           | 0.5                        | 13                               | 0.8                              |
| SLP 07 S01 | 0.7                  | 85                       | 16                          | 1.0                        | 25                               | 1.5                              |

\* At optimal operating pressure

\*\* At optimal operating pressure

| Type       | Sound level suction [dB(A)] | Sound level free [dB(A)] | Optimal operating pressure [bar] | Recomm. internal hose diameter compressed air [mm]* | Weight [g] | Operating temperature [°C] |
|------------|-----------------------------|--------------------------|----------------------------------|---|------------|----------------------------|
| SLP 05 S01 | 52                          | 60                       | 4.5                              | 2   | 5          | 0 ... 60 °C                |
| SLP 07 S01 | 63                          | 63                       | 4.5                              | 2   | 5          | 0 ... 60 °C                |

\* For max. length 2 m

# Inline Ejectors SLP

Suction rate from 8 l/min to 16 l/min

## Performance Data Inline Ejectors SLP

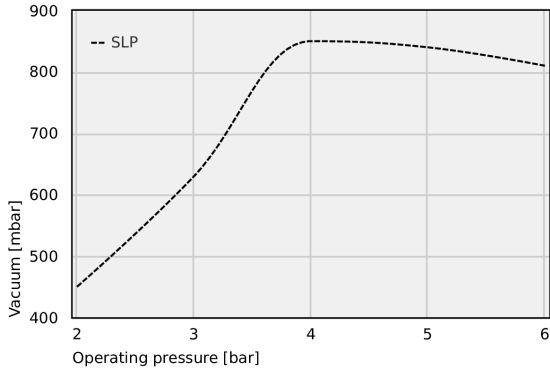

Achievable vacuum at various operating pressures

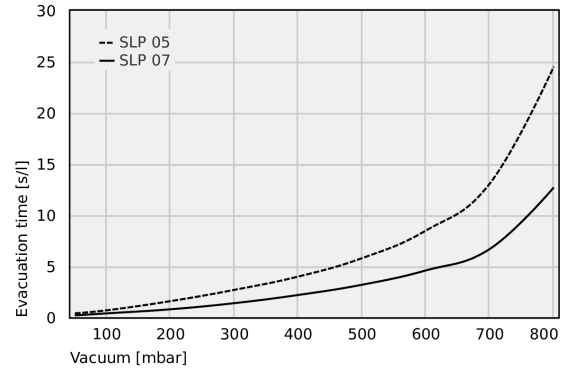

Evacuation times for various vacuum ranges [s/l]

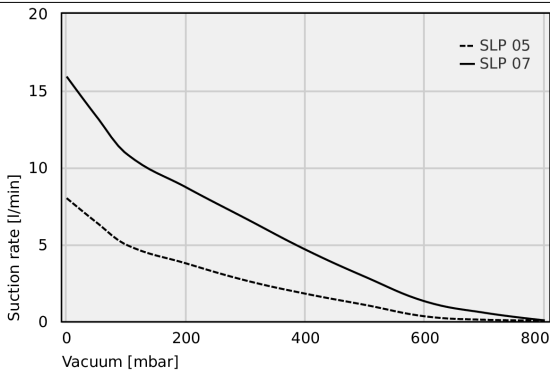

Suction capacity at various degrees of evacuation [l/min]

## Achievable vacuum at various operating pressures

|     | 2      | 3      | 4      | 5      | 6      |
|-----|--------|--------|--------|--------|--------|
| SLP | 450.00 | 630.00 | 850.00 | 840.00 | 810.00 |

## Inline Ejectors SLP

Suction rate from 8 l/min to 16 l/min

### 📄 Evacuation times for various vacuum ranges [s/l]

|        | 50   | 100  | 200  | 300  | 400  | 500  | 600  | 700   | 800   |
|--------|------|------|------|------|------|------|------|-------|-------|
| SLP 05 | 0.40 | 0.70 | 1.60 | 2.70 | 4.00 | 5.80 | 8.50 | 13.10 | 24.50 |
| SLP 07 | 0.20 | 0.40 | 0.80 | 1.40 | 2.20 | 3.20 | 4.60 | 6.70  | 12.70 |

### 📄 Suction capacity at various degrees of evacuation [l/min]

|        | 0     | 50    | 100   | 200  | 300  | 400  | 500  | 600  | 700  | 800  |
|--------|-------|-------|-------|------|------|------|------|------|------|------|
| SLP 05 | 8.00  | 6.42  | 4.97  | 3.76 | 2.65 | 1.79 | 1.06 | 0.32 | 0.10 | 0.05 |
| SLP 07 | 15.90 | 13.30 | 10.89 | 8.70 | 6.67 | 4.65 | 2.88 | 1.29 | 0.55 | 0.06 |

## Inline Ejectors SLP

Suction rate from 8 l/min to 16 l/min

### Design Data Inline Ejectors SLP

---

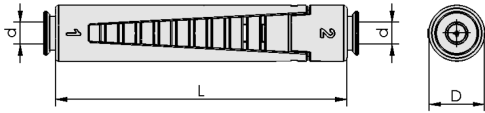

---

SLP

## Inline Ejectors SLP

Suction rate from 8 l/min to 16 l/min

### Design Data Inline Ejectors SLP

| Type       | d [mm] | D [mm] | L [mm] |
|------------|--------|--------|--------|
| SLP 05 S01 | 4      | 10     | 57     |
| SLP 07 S01 | 4      | 10     | 57     |