

# Innospann Steel-Plate ISST

Hole grid measure 75 mm and 150 mm

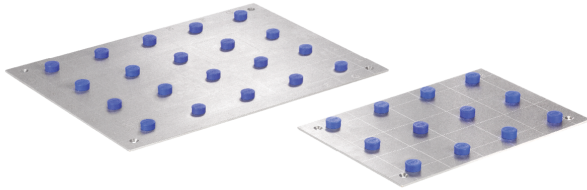

Innospann Steel-Plate ISST

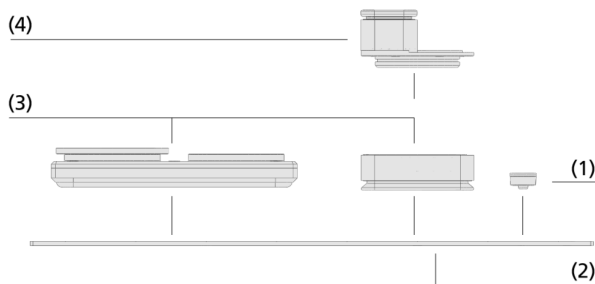

System design Innospann Steel-Plate ISST



Innospann Steel-Plate with Mono-Bases and suction cups

## Suitability for industry specific applications

### Applications

- Vacuum clamping system for retrofitting CNC machining centers with flat, grid or console tables
- Facilitates efficient and flexible single piece and small series production especially for the manufacture of furniture
- The suction cup mountings Mono-Base and Quad-Base are fitted with suction cups and can be positioned freely on the Steel-Plate
- A laser grid provides orientation assistance
- Unused vacuum openings can be closed manually using sealing magnets
- Variable total height through various suction cup heights and optional spacer rings

### Design

- Unused vacuum openings can be closed with sealing magnets (1)
- Innospann Steel-Plate (2) made from high-quality stainless or galvanized steel with integrated vacuum openings
- Suction cup mountings (3): Mono-Base or Quad-Base
- Suction cups (4) in various shapes

### Product highlights

- Can be retrofitted on all common machine types (flat, grid and console tables)
- Two different valve distances allow free positioning of Mono-Bases and Quad-Bases
- Lasered grid as orientation aid for positioning the suction cup
- Flexible use and short set-up times thanks to sealing magnets for uncovered vacuum openings

# Innospann Steel-Plate ISST

Hole grid measure 75 mm and 150 mm

## Designation code Innospann Steel-Plate ISST

<b>ISST</b>	–	<b>MS</b>	–	<b>variabel</b>	–	<b>75</b>
1		2		3		4

### 1 – Abbreviated designation

Code	Type
ISST	Innospann Steel-Plate

### 2 – Version

Code	Type
MS	Sealing magnet
TVR	Touch ball valve

### 3 – Dimensions

Code	LxWxH in mm
variabel	Variable

### 4 – Valve spacing

Code	Valve spacing in mm
75...150	75 and 150

The Steel-Plate ISST is delivered assembled. The product consists of:

- Stainless steel plate or galvanized steel made to measure with hole pattern and laser grid

Available accessories: sealing magnets