

DESCRIPTION

Solenoid valve 3 way
direct acting poppet type

CONSTRUCTION

Body	AISI 303
Armature tube	AISI 303
Plunger and core	AISI 430FR
Springs	AISI 302
Seal material	NBR - FPM - EPDM

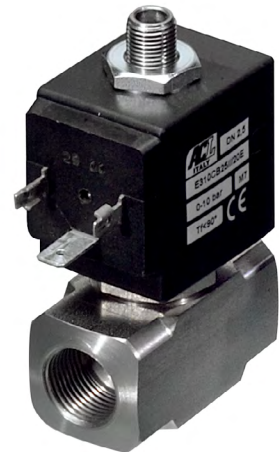

3

FEATURES

- Maximum allowable pressure PS 80bar^③
- Maximum fluid viscosity 25cSt (mm²/s)
- Ambient temperature: from -10°C to +80°C according to the coil
- Universal mounting position

OPTIONS: Silver shading ring
c us certified coils

ON REQUEST: Versions for use with fluid temperature at -40°C
Versions with 3/8" or 1/2" connections

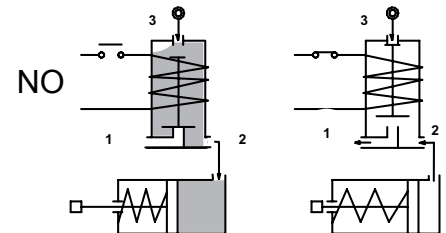
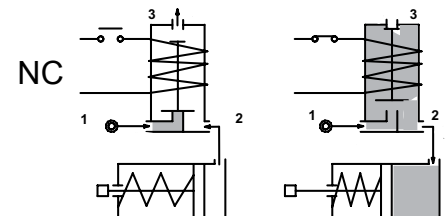
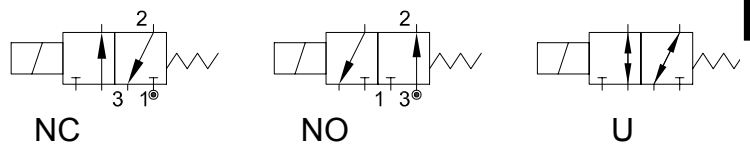

CODE ① ②	Connection G ISO 228	Orifice mm		Kv m ³ /h	Differential pressure bar			Nominal power			Coil		Seal ①	Temp. range °C		
		1→2	2→3		Min	Max	AC	DC	Inrush	VA Holding	DC Watt	Series			Width	
NC Normally closed																
E310B...20///...	1/4"	2	2.4	0.11	0	13	13	20	15	10	2	30	NBR=B	-10 +90		
E310B...25///...		2.5	2.4	0.16	0	10	10									
NO Normally open																
E310B...25/S/...	1/4"	2.4	2.5	0.16	0	9	9	20	15	10	2	30			EPDM=E	-10 +140
E310B...29/S/...		2.9	3	0.20	0	6.5	6.5									
U Universal																
E310B...25/G/...	1/4"	2.5	2.4	0.16	0	5	4	20	15	10	2	30	FPM=V	-10 +140		

① Seal Example: E310BV15///20B FPM seal Coil 24V 50/60Hz NC
② Coil E310BB24/S/201 NBR seal Coil 24V DC NO

③ The maximum allowable pressure PS for steam 2,5bar (gauge pressure)

COILS ②	Alternating Current 50/60Hz (V)							Direct Current (V)			Electrical connection	Connectors
	12	24	48	110	220 230	240	380	12	24	48		
Series 2 Width 30	20A	20B	20C	20D	20E	20F	20G	200	201	202	DIN 43650A	PG9 code 10349000

DESCRIPTION
 Class F insulation
 Voltage tolerance
 AC +15% -10%
 DC ± 10%
 Protection class
 IP65 with connector fitted
 IP00 without connector
 Continuous service ED100%

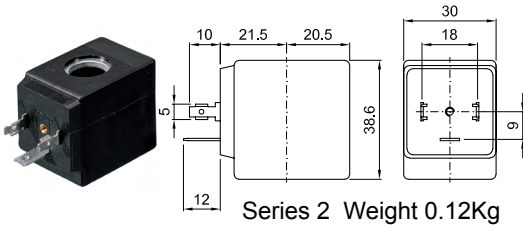

Series 2 Weight 0.12Kg

OPTIONS
 Class H insulation
 Cable attached
 Special coil voltage
 Special coil powers
 US certified coils

(for coil details see section 8)

SPARE PARTS LIST

1. Coil fixing nut
2. Coil
3. Plunger
4. Armature tube assembly

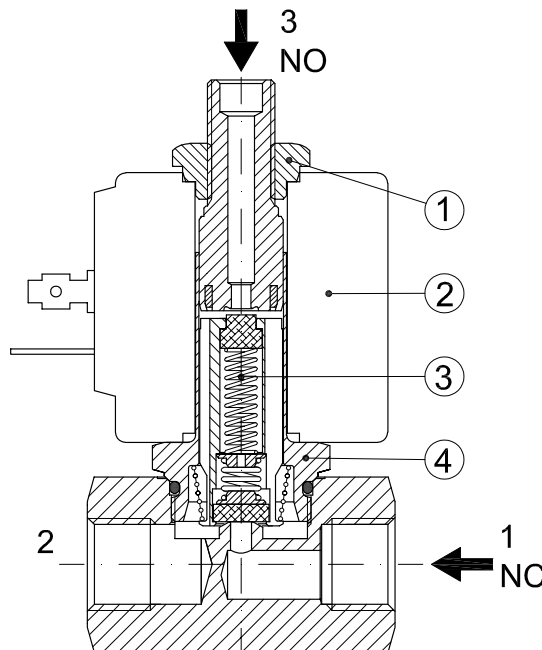

OVERALL DIMENSION

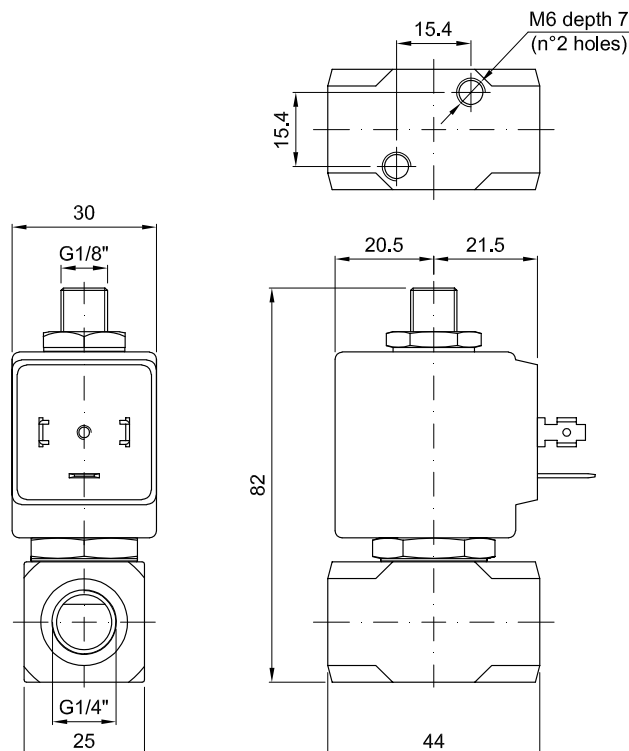

Weight=0.36Kg