

Flat Suction Cups (Round)



Suction Plates SUF

Suction area (Ø) from 125 mm to 210 mm



Suction Plates SUF

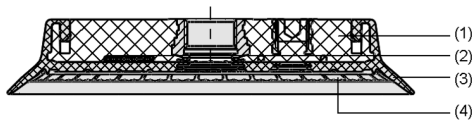

System Design Suction Plates SUF

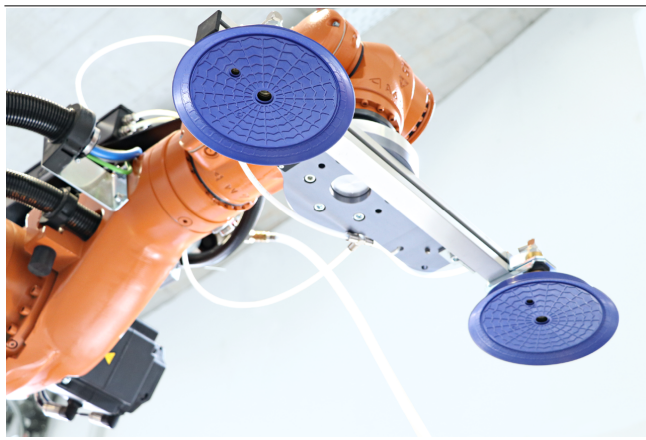

Suction plates SUF for handling glass plates

Suitability for Industry Specific Applications

Applications

- Round suction plate for handling of flat, smooth workpieces such as sheet metal, plastic, coated timber, granite or concrete
- For universal use in handling processes in vacuum automation and with manual vacuum lifting devices
- Use in processes requiring high suction forces or acceleration
- Use in dirty environmental conditions such as oil
- Handling thin-walled workpieces such as thin metal sheets

Design

- Reinforced plastic supporting plate (1)
- Integrated NFC-interface (2)
- Replaceable sealing ring (3) with special friction structure (4) and optimized sealing edge

Product Highlights

- Weight reduction by 30 % due to a carrier plate made of reinforced plastic
- Sealing ring made of oil and ozone-resistant NBR with optimised friction structure for increased suction and lateral force
- Innovative connection between supporting plate and sealing ring simplifies replacement and protects against twisting
- Read out product information via NFC interface with the smartphone and carry out replacement procurement

Suction Plates SUF

Suction area (Ø) from 125 mm to 210 mm

Designation Code Suction Plates SUF

SUF 1	–	210 2	–	NBR-60 3	–	G1/2-IG 4	–	VRS 5
-----------------	---	-----------------	---	--------------------	---	---------------------	---	-----------------

1 – Abbreviated designation		2 – Suction area		3 – Material	
Code	Version	Code	Diameter in mm	Code	Material
SUF	Flat	125...210	ø 125 to 210	NBR-60	Nitrile cautchuc

4 – Connection		5 – Product addition	
Code	Connection	Code	Connection
G1/4-IG	G1/4-IG	VRS	Screw plug
G1/2-IG	G1/2-IG		







Suction plate SUF (sealing ring + support plate) is delivered pre-assembled. The product consists of:

- Sealing ring of type DR-SUF – elastomer part, available in various diameters
- Reinforced plastic support plate with various threads

Available spare parts: sealing ring DR-SUF

Available accessories: touch valve TV, screen

Ordering Data Suction Plates SUF

Type	Part no.
SUF 125 NBR-60 G1/4-IG	10.01.01.14521 
SUF 125 NBR-60 G1/4-IG VRS	10.01.01.14316 
SUF 160 NBR-60 G1/2-IG	10.01.01.14522 
SUF 160 NBR-60 G1/2-IG VRS	10.01.01.14330 
SUF 210 NBR-60 G1/2-IG	10.01.01.14523 
SUF 210 NBR-60 G1/2-IG VRS	10.01.01.13536 

Ordering Data Spare Parts Suction Plates SUF

Type	Spare Parts	Part no.
SUF 125	Sealing ring for SUF suction plate	DR-SUF 125 NBR-60 10.01.01.14319
SUF 160	Sealing ring for SUF suction plate	DR-SUF 160 NBR-60 10.01.01.14327
SUF 210	Sealing ring for SUF suction plate	DR-SUF 210 NBR-60 10.01.01.13846

Ordering Data Accessories Suction Plates SUF

Type	Accessories	Part no.
SUF 125 NBR-60 G1/4-IG	Sieve, round	SIEB 15x0.8 MS-A2 0.103/0.07 10.07.01.00211
SUF 125 NBR-60 G1/4-IG VRS	Sieve, round	SIEB 15x0.8 MS-A2 0.103/0.07 10.07.01.00211
SUF 160 NBR-60 G1/2-IG	Sieve, round	SIEB 27x1 MS-A2 100 10.07.01.00110
SUF 160 NBR-60 G1/2-IG VRS	Sieve, round	SIEB 27x1 MS-A2 100 10.07.01.00110
SUF 210 NBR-60 G1/2-IG	Sieve, round	SIEB 27x1 MS-A2 100 10.07.01.00110
SUF 210 NBR-60 G1/2-IG VRS	Sieve, round	SIEB 27x1 MS-A2 100 10.07.01.00110

Type	Accessories	Part no.
SUF 125	Touch Valve	TV G1/8-AG 10 10.05.10.00088
SUF 160	Touch Valve	TV G1/4-AG 12 10.05.10.00086
SUF 210	Touch Valve	TV G1/4-AG 12 10.05.10.00086

Suction Plates SUF

Suction area (Ø) from 125 mm to 210 mm

Technical Data Suction Plates SUF

Type		Suction force (-600 mbar) [N]*	Suction force d2 [N]**	Volume [cm³]	Workpiece radius min. (convex) [mm]
SUF	125	730	450	96	250
SUF	160	1,200	790	176	400
SUF	210	2,070	1,400	362	750

*The specified suction forces are theoretical values at a vacuum of -0.6 bar and with a smooth, dry workpiece surface - they do not include a safety factor

**Suction force referred to the sealing-edge diameter d2

Suction Plates SUF

Suction area (\emptyset) from 125 mm to 210 mm

Design Data Suction Plates SUF

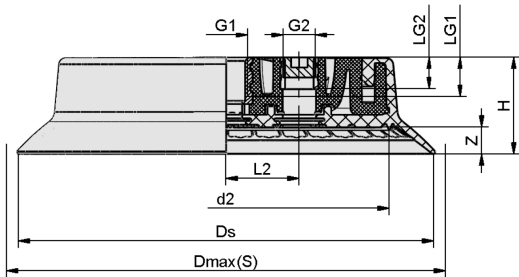

SUF 125

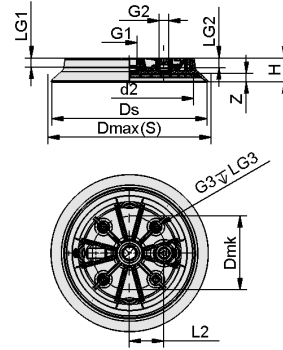

SUF 160 - 210

Suction Plates SUF

Suction area (Ø) from 125 mm to 210 mm

Design Data Suction Plates SUF

Type		d2 [mm]	Dmax(S) [mm]	Dmk [mm]	Ds [mm]	G1	G2	G3	H [mm]	L2 [mm]	LG1 [mm]	LG2 [mm]	LG3 [mm]	Z [mm]
SUF	125	98.0	132	-	125	G1/4"-F	G1/8"-F	-	29	22.0	11.8	9.5	-	8
SUF	160	130.0	170	66.5	160	G1/2"-F	G1/4"-F	M8-F	30	32.5	14.0	11.8	11.1	9
SUF	210	172.9	220	100.0	210	G1/2"-F	G1/4"-F	M8-F	32	46.5	12.2	11.8	11.1	11

Multimedia product presentation

Medium	Link
Product video	https://vimeo.com/380455243